

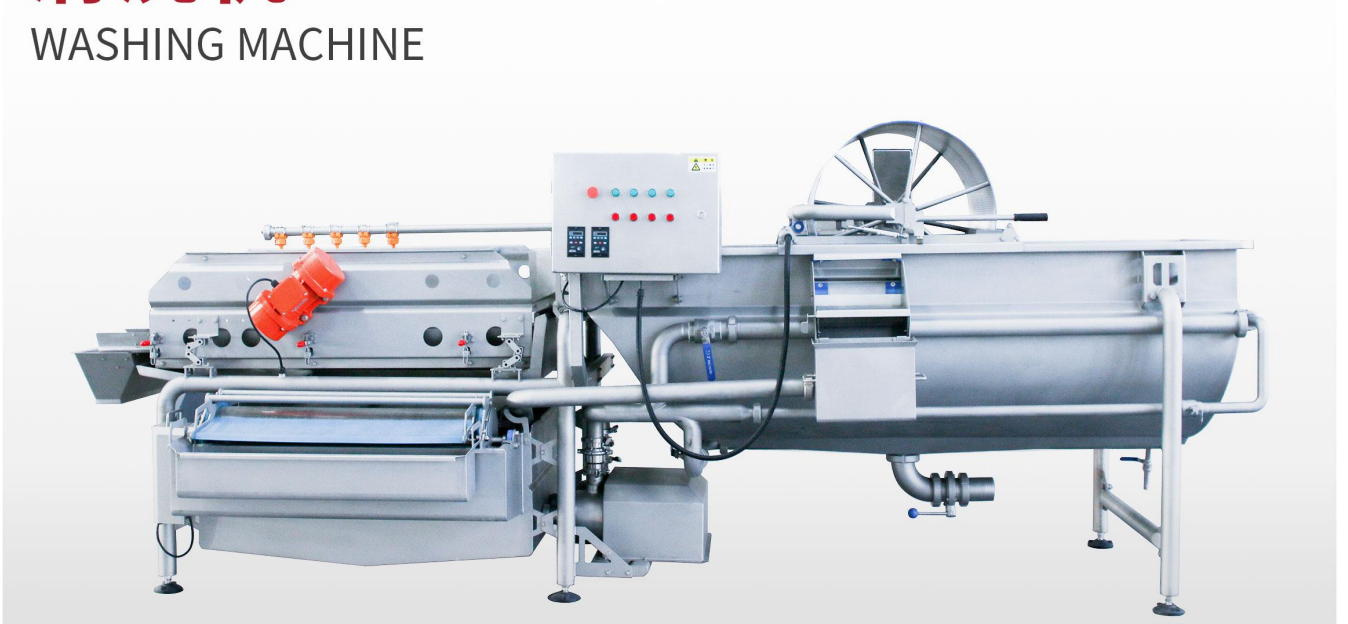

清洗机

WASHING MACHINE



工作原理

卧式混流喷冲清洗系列产品是采用卧式混流喷冲清洗原理和快拆装式转笼去杂原理，同振动沥水原理相结合，通过阀门、管路、水泵及电器元件组合，连接控制完成食品物料的全面清洗以及物料杂质分离的目的。

WORKING PRINCIPLE

The horizontal mixed-flow spray cleaning series products adopt the principle of horizontal mixed-flow spray cleaning and the principle of quick-disassembling type cage to remove impurities. Combined with the principle of vibration and drainage, through the combination of valves, pipelines, pumps and electrical components, the connection control is completed. The overall cleaning of food materials and the purpose of separation of material impurities.

— 尺寸及参数 *_Size And Parameters*

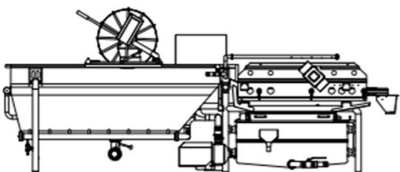
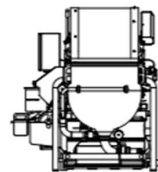
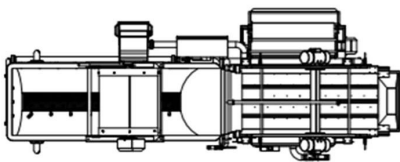

功率
Power

3.5KW

电压
Voltage

380VAC

清洗速度
Cleaning Speed

200KG/H



部件结构图

_Component Structure

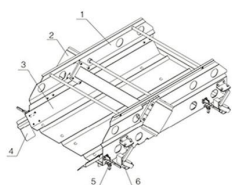

可调式振动沥水装置
Adjustable Vibrating Drain Device

- | | |
|--------|--------------------------|
| 1、振动边板 | 1, vibrating edge board |
| 2、振动电机 | 2, vibration motor |
| 3、振动筛网 | 3, vibrating screen |
| 4、出料挡片 | 4, the output baffle |
| 5、压紧把手 | 5, press the handle |
| 6、减震弹簧 | 6, shock absorber spring |

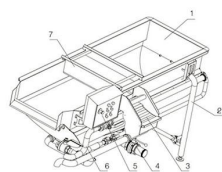

清洗槽体装置
Cleaning Tank Device

- | | |
|----------|-----------------------------------|
| 1、槽体 | 1, the tank body |
| 2、支腿装置 | 2, leg device |
| 3、楔形丝网过滤 | 3, the shape of the screen filter |
| 4、排污装置 | 4, sewage device |
| 5、电控箱 | 5, electric control box |
| 6、循环管理系统 | 6, cycle management system |
| 7、过滤压网装置 | 7, filter press network device |

优势特点

_Advantage

- | | |
|-------------------------------------------------------------------------------------------|-------------------------------------------------------------------------------------------------------------------------------------------------------------------------|
| <ul style="list-style-type: none"> 螺旋状混合水流清洗物料，物料清洗充分，时间长，用水少 | <p>Spiral mixed water flow cleaning material, material cleaning is sufficient, time is long, water is low</p> |
| <ul style="list-style-type: none"> 锥型沉沙底部，分离泥沙、杂质，便于集中存储、排放 | <p>Cone-shaped sedimentation bottom, separating sediment and impurities, facilitating centralized storage and discharge</p> |
| <ul style="list-style-type: none"> 排污口采用360°水平旋转，适用于不同车间设计需求 | <p>The sewage outlet adopts 360° horizontal rotation, which is suitable for different workshop design requirements.</p> |
| <ul style="list-style-type: none"> 沥水装置可调，输送不同轻重物料，不同沥水筛面快速拆卸、更换、清洗 | <p>The draining device is adjustable, conveying different light and heavy materials, and different drain screens are quickly disassembled, replaced and cleaned.</p> |
| <ul style="list-style-type: none"> 可翻转快拆装式滚笼，采用高精度楔形滚筒，自动连续过滤，自动收集杂质，实现水循环 | <p>Reversible quick-disconnecting roller cage, high-precision curved roller, automatic continuous filtration, automatic collection of impurities, water circulation</p> |
| <ul style="list-style-type: none"> 快拆去杂装置，用于自动排杂除虫，采用卡槽定位设计，无须固定，快速拆卸 | <p>Quickly remove the miscellaneous device for automatic de-worming, adopting the card slot positioning design, no need to fix, quick disassembly</p> |



JOIN AUTOMATION MECHANICAL TECHNOLOGY CO.,LTD
No. 19 Zhulong Road, Xitong Science & Technology Industrial Park

锦岸机械科技江苏有限公司
江苏省南通锡通科技产业园竹松路19号

TEL: 0513-86318999
FAX: 0513-86328555

EMAIL: jcn@jinantec.com
WEB: www.jinantec.com

